

New Holland Auto Group
Presents...



The 2015 Ford F-350 XL
4x4 SD Super Cab 8' box 158" WB SRW



Prepared For: Mr. Gus Belmont
Prepared By: Jordan DiClemente
Prepared On: January 09, 2015



New Holland Auto Group

January 09, 2015

Mr. Gus Belmont
Whitpain Township
960 Wentz Road
Blue Bell Pa, Pennsylvania, 19422
Phone: (610) 227-2400

Re: The 2015 Ford F-350 XL

Dear Mr. Belmont,

Thank you very much for your interest in acquiring a vehicle from our dealership. We concur that your interest is well deserved. We hope that an outstanding product lineup and our dedication to customer service will enhance your ownership experience should you decide to buy a vehicle from us.

Attached, please find additional information that I hope will assist you in making a more informed decision. Please feel free to contact me at any time as I would truly appreciate the opportunity to be of service to you.

Sincerely,

Jordan DiClemente
Government Fleet Sales
717-354-4910 x 223
jdiclemente@newhollandauto.com

Prepared For:
Mr. Gus Belmont
Whitpain Township
960 Wentz Road
Blue Bell Pa, Pennsylvania, 19422
Phone: (610) 227-2400

Prepared By:
Jordan DiClemente
New Holland Auto Group
508 W. Main Street
New Holland, Pennsylvania, 17557



Table of Contents

2015 Ford F-350

4x4 SD Super Cab 8' box 158" WB SRW XL (X3B)

Description	Page
Cover Page	1
Cover Letter	2
Table of Contents	3
Vehicle Profile	4
Selected Options	6
Quotation	9

Prepared For:
Mr. Gus Belmont
Whitpain Township
960 Wentz Road
Blue Bell Pa, Pennsylvania, 19422
Phone: (610) 227-2400

Prepared By:
Jordan DiClemente
New Holland Auto Group
508 W. Main Street
New Holland, Pennsylvania, 17557



Vehicle Profile

2015 Ford F-350

4x4 SD Super Cab 8' box 158" WB SRW XL (X3B)

Powertrain

6.2L V-8 SOHC SMPI 16 valve engine with variable valve control * 200 amp HD alternator * 650 amp 72 amp hours (Ah) HD battery with run down protection * Transmission oil cooler * 6-speed electronic SelectShift automatic transmission with overdrive, lock-up, driver selection * Part-time four-wheel drive with manual transfer case shift, manual locking hubs * ABS & driveline traction control * 3.73 axle ratio * Stainless steel exhaust

Steering and Suspension

Hydraulic power-assist re-circulating ball steering * 4-wheel disc brakes with front and rear vented discs * Firm ride suspension, with AdvanceTrac w/Roll Stability Control electronic stability stability control with anti-roll * Mono-beam non-independent front suspension * Front anti-roll bar * HD front coil springs * HD front shocks * Rigid rear axle * Rear leaf suspension * HD rear leaf springs * HD rear shocks * Front and rear 17.0" x 7.50" argent steel wheels with hub covers * LT245/75SR17.0 BSW AT front and rear tires * Underbody w/crankdown mounted full-size steel spare wheel

Safety

4-wheel anti-lock braking system * Center high mounted stop light * Dual airbags, passenger side front-impact cancellable airbag, seat mounted driver and passenger side-impact airbags, curtain 1st and 2nd row overhead airbags * Front height adjustable seatbelts * SecuriLock immobilizer, panic alarm, security system

Comfort and Convenience

Air conditioning, underseat ducts * AM/FM stereo, clock, seek-scan, 2 speakers, fixed antenna * Power door locks with 2 stage unlock, keyfob (front doors) keyless entry * 2 12V DC power outlets, retained accessory power * Analog instrumentation display includes tachometer, oil pressure gauge, engine temperature gauge, transmission fluid temp gauge, engine hour meter, exterior temp, systems monitor, trip odometer * Warning indicators include oil pressure, engine temperature, battery, lights on, key, low fuel, door ajar, service interval, brake fluid, low tire pressure * Steering wheel with tilt and telescopic adjustment * Power front windows and vented rear windows with light tint, driver and passenger 1-touch down * Variable intermittent front windshield wipers * Passenger side vanity mirror * Day-night rearview mirror * Interior lights include dome light with fade, front reading lights, illuminated entry * Full overhead console with storage, glove box, front cupholder, instrument panel bin, dashboard storage, driver and passenger door bins * Upfitter switches

Seating and Interior

Seating capacity of 6 * 40-20-40 split-bench front seat with adjustable head restraints, center armrest with storage * 4-way adjustable driver seat includes lumbar support * 4-way adjustable passenger seat * 60-40 folding rear split-bench seat with fold-up cushion, 2 fixed rear head restraints * Vinyl faced front seats with vinyl back material * Vinyl faced rear seats with carpet back material * Full cloth headliner, full vinyl/rubber floor covering, urethane gear shift knob, chrome interior accents

Exterior Features

Prices and content availability as shown, are subject to change and should be treated as estimates only. Actual base vehicle, package and option pricing may vary from this estimate because of special local pricing, availability or pricing adjustments not reflected in the dealer's computer system. See salesperson for the most current information. Reference CT05210374 12/1/2014

Vehicle Profile Continued

Prepared For: Mr. Gus Belmont
Prepared By: Jordan DiClemente
Dealership: New Holland Auto Group

Exterior Features (Continued)

Side impact beams, front license plate bracket, fully galvanized steel body material * Black side window moldings, black front windshield molding * Black door handles * Black grille * 4 doors with reverse opening rear driver's side door, reverse opening rear passenger's side door * Class V trailering, trailer hitch, brake controller, trailer sway control * Driver and passenger power remote black heated convex spotter folding manual extendable trailer outside mirrors with turn signal indicators * Front black bumper with front tow hooks * Aero-composite halogen headlamps * Additional exterior lights include pickup cargo box light, underhood light, remote activated perimeter/approach lights * Clearcoat monotone paint * Snow plow provision

Warranty

Basic	36 month/36,000 miles	Powertrain	60 month/60,000 miles
Corrosion Perforation	60 month/unlimited mileage	Roadside Assistance	60 month/60,000 miles

Dimensions and Capacities

Output	316 hp @ 4,179 rpm	Torque	397 lb.-ft. @ 4,179 rpm
1st gear ratio	3.974	2nd gear ratio	2.318
3rd gear ratio	1.516	4th gear ratio	1.149
5th gear ratio	0.858	6th gear ratio	0.674
Reverse gear ratio	3.128	Curb weight	6,469 lbs.
GVWR	10,700 lbs.	Front	6,000 lbs.
Rear GAWR	6,290 lbs.	Payload	4,010 lbs.
Front curb weight	3,976 lbs.	Rear curb weight	2,493 lbs.
Front axle capacity	6,000 lbs.	Rear axle capacity	7,280 lbs.
Front spring rating	6,000 lbs.	Rear spring rating	7,000 lbs.
Front tire/wheel capacity	6,390 lbs.	Rear tire/wheel capacity	6,390 lbs.
Towing capacity	12,300 lbs.	5th-wheel towing capacity	12,200 lbs.
Front legroom	41.1 "	Rear legroom	31.6 "
Front headroom	40.7 "	Rear headroom	38.1 "
Front hiproom	67.6 "	Rear hiproom	67.3 "
Front shoulder room	68.0 "	Rear shoulder room	68.1 "
Passenger area volume	113.3 cu.ft.	Length	248.6 "
Body width	79.9 "	Body height	80.2 "
Wheelbase	158.0 "	Cab to axle	56.4 "
Axle to end of frame	47.6 "	Front track	68.3 "
Rear track	67.2 "	Turning radius	26.2 '
Fuel tank	35.0 gal.	Interior cargo volume	39.5 cu.ft.
Interior maximum cargo volume	39.5 cu.ft.		

Prices and content availability as shown, are subject to change and should be treated as estimates only. Actual base vehicle, package and option pricing may vary from this estimate because of special local pricing, availability or pricing adjustments not reflected in the dealer's computer system. See salesperson for the most current information. Reference CT05210374 12/1/2014

Prepared For:
Mr. Gus Belmont
Whitpain Township
960 Wentz Road
Blue Bell Pa, Pennsylvania, 19422
Phone: (610) 227-2400

Prepared By:
Jordan DiClemente
New Holland Auto Group
508 W. Main Street
New Holland, Pennsylvania, 17557



Selected Options

2015 Ford F-350

4x4 SD Super Cab 8' box 158" WB SRW XL (X3B)

Vehicle Snapshot

Engine: 6.2L 2-Valve SOHC EFI NA V8 Flex-Fuel
Transmission: TorqShift 6-Speed Automatic
Rear Axle Ratio: Electronic Locking w/3.73
GVWR: 10,700 lb Payload Package

Code	Description	Class	MSRP
X3B	Base Vehicle Price (X3B)	STD	37,330.00
Packages			
610A	Order Code 610A (996) Engine: 6.2L 2-Valve SOHC EFI NA V8 Flex-Fuel; (44P) Transmission: TorqShift 6-Speed Automatic : Includes SelectShift.; (X37) 3.73 Axle Ratio; (STDGV) GVWR: 10,700 lb Payload Package; (TBK) Tires: LT245/75R17E BSW A/S; (64A) Wheels: 17" Argent Painted Steel : Includes painted hub covers/center ornaments.; (A) HD Vinyl 40/20/40 Split Bench Seat : Includes center armrest, cupholder and storage.; (587) Radio: AM/FM Stereo w/Digital Clock : Includes 2 speakers.	OPT	N/C
Emissions			
425	50 State Emissions	OPT	N/C
Powertrain			
996	Engine: 6.2L 2-Valve SOHC EFI NA V8 Flex-Fuel Torque: 397 ft.lbs. @ 4179 rpm.	INC	Included
44P	Transmission: TorqShift 6-Speed Automatic Includes SelectShift.	INC	Included
X3E	Electronic Locking w/3.73 Axle Ratio	OPT	390.00
STDGV	GVWR: 10,700 lb Payload Package	INC	Included
Wheels & Tires			
TBM	Tires: LT245/75R17E BSW A/T	OPT	125.00
64A	Wheels: 17" Argent Painted Steel Includes painted hub covers/center ornaments.	INC	Included

Prices and content availability as shown, are subject to change and should be treated as estimates only. Actual base vehicle, package and option pricing may vary from this estimate because of special local pricing, availability or pricing adjustments not reflected in the dealer's computer system. See salesperson for the most current information. Reference CT05210374 12/1/2014

Selected Options Continued

Prepared For: Mr. Gus Belmont
 Prepared By: Jordan DiClemente
 Dealership: New Holland Auto Group

Code	Description	Class	MSRP
512	Spare Tire, Wheel, Carrier & Jack <i>Spare tire is standard equipment; becomes optional when (66D) Pickup Box Delete is ordered.</i>	OPT	295.00
Seats & Seat Trim			
A	HD Vinyl 40/20/40 Split Bench Seat <i>Includes center armrest, cupholder and storage.</i>	INC	Included
Other Options			
158WB	158" Wheelbase	STD	N/C
90L	Power Equipment Group <i>Accessory Delay; Manual Telescoping 2-Way Fold Trailer Tow Mirrors : Includes power/heated glass, heated convex spotter mirror and integrated clearance lamps/turn signals.; Perimeter Anti-Theft Alarm; Power Locks; Power 1st Row Front-Seat Windows : Includes 1-touch up/down.; Remote Keyless Entry. Deletes passenger-side lock cylinder. Includes upgraded door trim panel.</i>	OPT	895.00
473	Snow Plow Prep Package <i>Includes computer selected springs for snowplow application and heavy duty alternator. NOTE: Restrictions apply; see Supplemental Reference or Body Builders Layout Book for details.</i>	OPT	85.00
66D	Pickup Box Delete <i>Rear Bumper Delete; Spare Wheel, Tire, Carrier & Jack Delete. Deletes tie-down hooks, tailgate, bodyside moldings and 7/4 pin connector. Includes 17.5K trailer hitch receiver (see Trailer Tow guide for rating). Incomplete vehicle package - requires further manufacture and certification by a final stage manufacturer. In addition, Ford urges manufacturers to follow the recommendations of the Ford Incomplete Vehicle Manual and the Ford Truck Body Builder's Layout Book (and applicable supplements).</i>	OPT	(625.00)
67D	Extra Heavy Duty 200-Amp Alternator	OPT	75.00
52B	Trailer Brake Controller (TBC) <i>Compatible with select electric over hydraulic brakes.</i>	OPT	270.00
PAINT	Monotone Paint Application	STD	N/C
66S	Upfitter Switches (4) <i>Located on instrument panel.</i>	OPT	125.00
587	Radio: AM/FM Stereo w/Digital Clock <i>Includes 2 speakers.</i>	INC	Included
Interior Colors For : Primary w/XL			
AS	Steel	OPT	N/C
Primary Colors For : Primary w/XL			
Z1	Oxford White	OPT	N/C
Accessories and Aftermarket Options			
NHA	New Holland Advantage <i>Completley Detailed Vehicle Free Delivery to Your Location Full Tank Of Fuel Free Municipal Tags</i>		\$0.00
DEJA	Dejana Truck Body Upfit <i>As per quote #GB001159</i>		\$17,580.00

Prices and content availability as shown, are subject to change and should be treated as estimates only. Actual base vehicle, package and option pricing may vary from this estimate because of special local pricing, availability or pricing adjustments not reflected in the dealer's computer system. See salesperson for the most current information. Reference CT05210374 12/1/2014

Selected Options Continued

Prepared For: Mr. Gus Belmont
Prepared By: Jordan DiClemente
Dealership: New Holland Auto Group

Code	Description	Class	MSRP
Vehicle Subtotal			\$56,545.00
Destination			\$1,195.00
Vehicle Subtotal (including Destination)			\$57,740.00

Prices and content availability as shown, are subject to change and should be treated as estimates only. Actual base vehicle, package and option pricing may vary from this estimate because of special local pricing, availability or pricing adjustments not reflected in the dealer's computer system. See salesperson for the most current information.
Reference CT05210374 12/1/2014

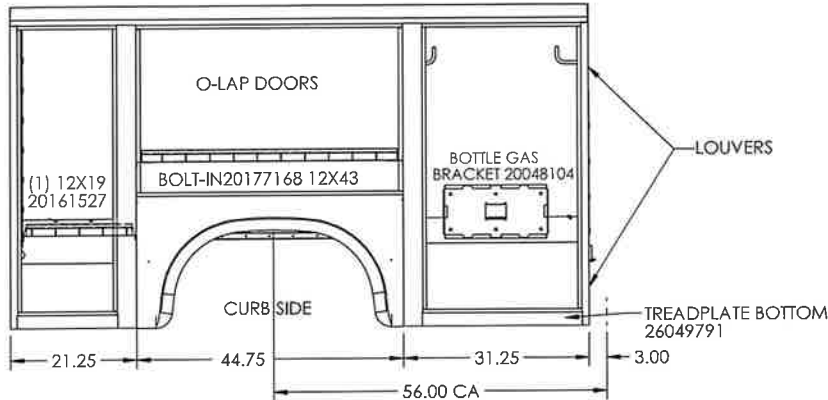

696JX54 BODY

- DBL SPRING DOOR RETAINERS INSTALLED
- HIGH LIGHT HOLES PRE PUNCHED
- LIGHT GUARDS INSTALLED EA RR END PNL
- BOTTLE GAS RETAINER INSTALLED PER 20002648
- E-TRACK INSTALLED AS SHOWN
- 4 CARGO TIE DOWNS PER 20211314
- E-COAT PRIME AND UNDERCOAT

ITEMS INSTALLED AFTER E-COAT.

- DOOR SEAL DELETED
- TAILGATE DELETED
- 3PT STAINLESS STEEL LATCHES
- ADJUSTABLE AND BOLT IN SHELVEING AS SHOWN.
- 28 DIVIDERS FOR SHELVES 20170494.

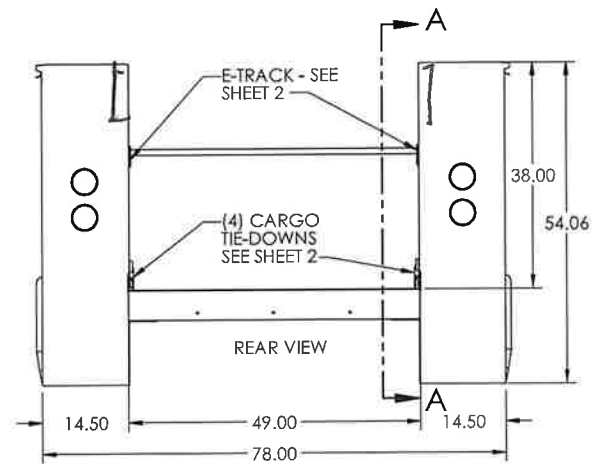
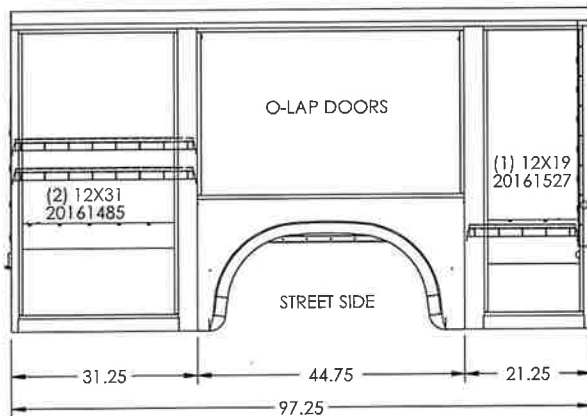

UNLESS OTHERWISE SPECIFIED
THE FOLLOWING RULES SHALL APPLY
ALL DIMENSIONS ARE IN INCHES
DIMENSIONS ARE TO CENTER UNLESS
OTHERWISE SPECIFIED
DIMENSIONS ARE TO CENTER UNLESS
OTHERWISE SPECIFIED
DIMENSIONS ARE TO CENTER UNLESS
OTHERWISE SPECIFIED

DRAWING TITLE:

WELD 696JX54 HLH OLAP HZ
E-TRK,4 CTD, NTG, 3PT DRS

MATERIAL:

WEIGHT:

1163.07

DATE:

03/09/15

REVISION:

A 1 of 2 1:24

REFERENCE DRAWING:

30833880

PART NUMBER:

31937460

QUANTITY:

00000